

THE CORPORATION OF THE TOWNSHIP OF WHITEWATER REGION

By-Law # 03-06-117

---

A By-law to amend By-law Number 23-92 of the former Corporation of the Township of Ross as amended.

---

PURSUANT TO SECTION 34 OF THE PLANNING ACT, THE TOWNSHIP OF WHITEWATER REGION HEREBY ENACTS AS FOLLOWS:

1. THAT By-law Number 23-92, as amended, be and the same is hereby further amended as follows:
  - (a) By adding the following new subsection to Section 5 - Requirements For Residential One (R1) Zones immediately following subsection 5.3 b):
    - “c) Residential One - Exception Three (R1-E3) Zone  
  
Notwithstanding any other provisions of this By-law to the contrary, for the lands located in the Residential One - Exception Three (R1-E3) Zone, within Part of Lot 21, Concession 2, geographic Township of Ross, no dwelling shall be erected within 200 metres of the centreline of a railway line.”
  - (b) Schedule “A-4” is amended by rezoning the lands described above from Open Space (OS) to Residential One - Exception Three (R1-E3) as shown on Schedule “A” attached hereto.
2. THAT save as aforesaid all other provisions of By-Law 23-92, as amended, shall be complied with.
3. This by-law shall come into force and take effect on the day of final passing thereof.

Read a First, Second and Finally passed on the Third Reading, this 4<sup>th</sup> day of June 2003

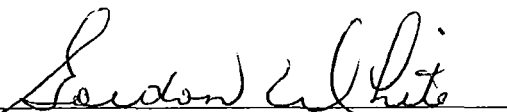
  
Reeve

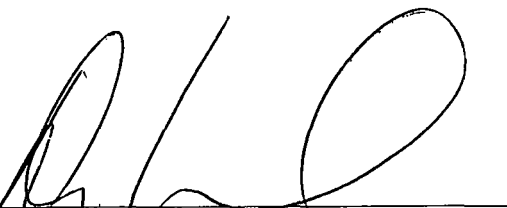
  
CAO/Clerk

Geographic Township  
of Ross

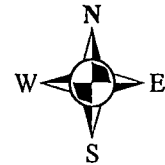

From OS to  
R1-E3

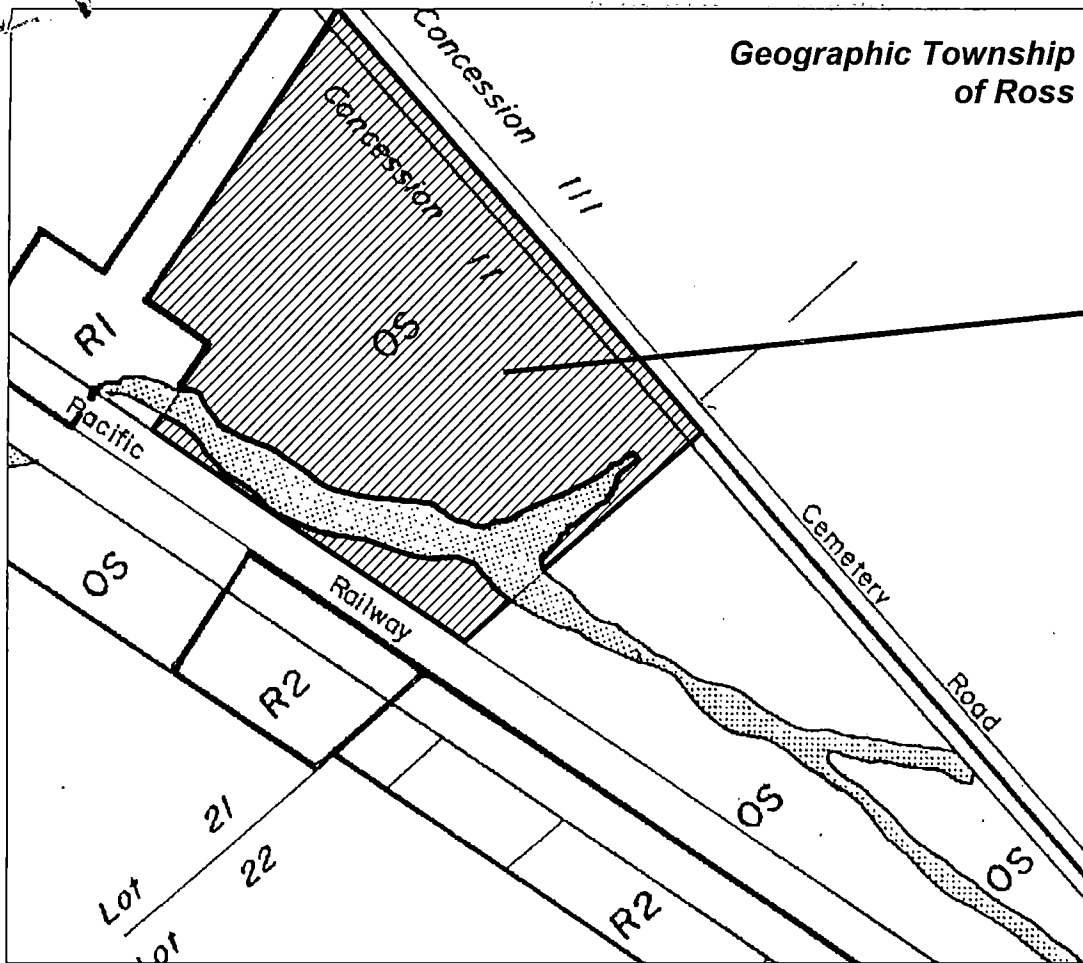

Scale  
1 inch equals 400 feet

**CORPORATION OF THE  
TOWNSHIP OF WHITEWATER REGION**

This is Schedule "A" to By-law Number 03-06-117  
Passed the 4<sup>th</sup> day of June 2003.

Signatures of Signing Officers:

Reeve

CAO/Clerk

**LEGEND**



Residential One



Environmental Protection



Residential Two



Exception Zone



Open Space



Area affected by this Amendment